

APPLICATION DETAILS	
APPLICATION	-
RATED POWER	-
RATED SPEED	-
RATED TORQUE	-
A.S.F.	-
COUPLING SPECIFICATIONS	
COUPLING RATING	58.5 KW @ 100 RPM
RATED TORQUE	5583 Nm
MAX. BORE	155 mm
WEIGHT (Approx.)	78.725 kg
INERTIA (WK ²)	0.524 kg.M ²
TORSIONAL STIFFNESS	1.239 NmN/rad
CPLG DYNAMIC BALANCED TO GR 6.3 AS PER ISO 1940- 1	
MAX. MISALIGNMENT	
AXIAL DEFLECTION	± 2 mm
ANGULAR DEFLECTION	0.75°
RADIAL MISALIGNMENT	0.013 mm

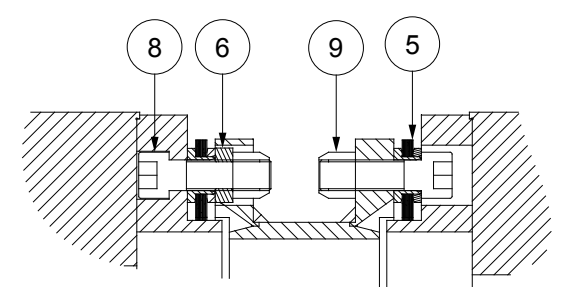

NOTE:-
 TIGHTENING TORQUE :-
 1) SR.NO.8 COUPLING BOLT = 250 Nm
 2) SR.NO.7 ATTACHMENT BOLT = 59 Nm

REV	DMRN NO.	DESCRIPTION	REV. BY	APPD. BY	DATE

SR.NO.	DESCRIPTION	MATERIAL	QTY.
9	CLEVELOCK NUT	GR. 10	12
8	COUPLING BOLT	AH BOLT GR. 12.9	12
7	ATTACHMENT_BOLT (IV)	AH BOLT GR. 12.9	12
6	SLEEVE	ASTM A 1040	6
5	ELEMENT BLADE ASSEMBLY	SS 301	2
4	SPACER	ASTM A-106B , ASTM A-36	1
3	ADAPTER III/IV	ASTM A 1040	2
2	DRIVEN HUB (IV)	ASTM A 1040	1
1	DRIVE HUB (IV)	ASTM A 1040	1

TITLE: REM-390(175)(IV/IV) /XXXX CPLG	MATERIAL: REFER TABLE	AUTHORITY	INITIALS	SIGN	DATE
CUSTOMER NAME:		DRAWN	XXX		14.01.19
		CHECKED	XXX		14.01.19
		APPROVED	XXX		14.01.19
		SCALE: 1:1	REF. NO.		
		ANG. OF PROJ.			
RATHI TRANSPower PVT LTD PUNE-411014					DRG.NO.: R/SD-XXXX/0

This drawing/information/design is the property of Rathi Transpower Pvt. Ltd. It is confidential & must not be made public or copied without prior written authorization & is subjected to recall at any time. Acceptance of this drawing constitutes full arrangements with these conditions.