

ERP CODE: \_\_\_\_\_

DRIVE SIDE

M10 SET SCREW ON KEYWAY.

M10 SET SCREW ON KEYWAY.

DRIVEN SIDE

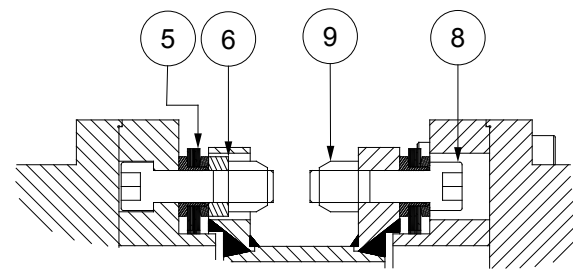
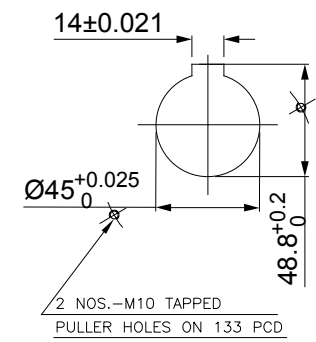
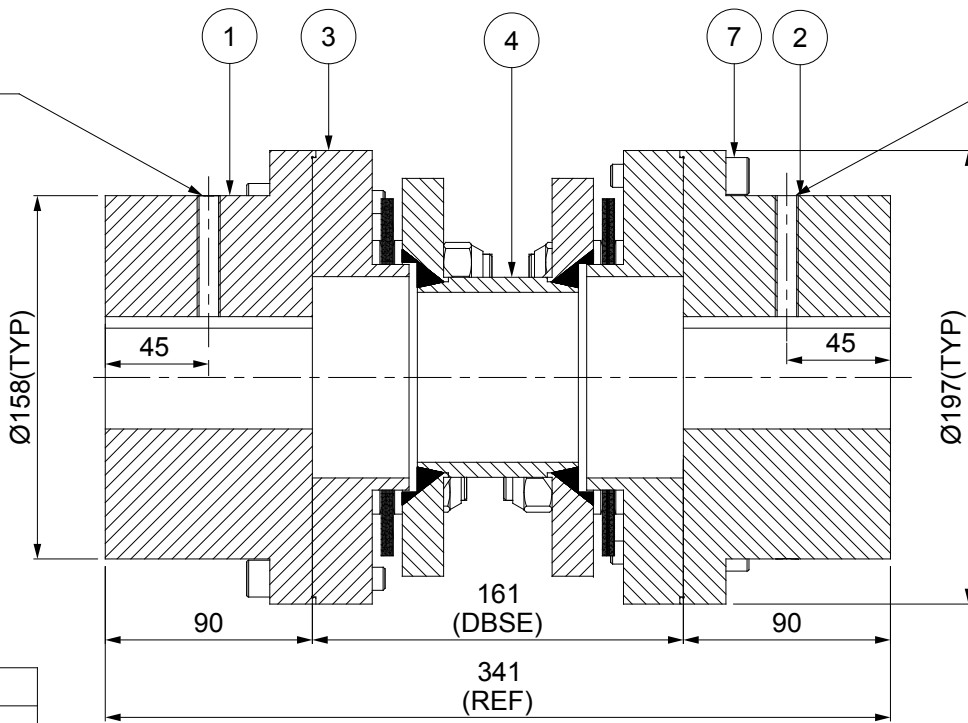
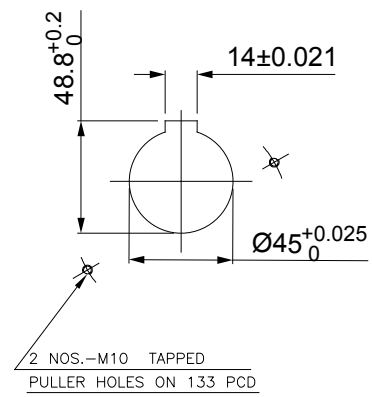

TIGHTENING TORQUE :-  
 1) SR.NO.8 COUPLING BOLT = 161 Nm  
 2) SR.NO.7 ATTACHMENT BOLT = 59 Nm

APPLICATION DETAILS	
APPLICATION	-
RATED POWER	-
RATED SPEED	-
RATED TORQUE	-
A.S.F.	-
COUPLING SPECIFICATIONS	
COUPLING RATING	36.3 KW @ 100 RPM
RATED TORQUE	3463 Nm
MAX. BORE	108 mm
WEIGHT (Approx.)	45.730 kg
INERTIA (WK <sup>2</sup> )	0.199 kg.M <sup>2</sup>
TORSIONAL STIFFNESS	0.749 MNm/rad
CPLG DYNAMIC BALANCED TO GR.6.3 AS PER ISO 1940- 1	
MAX. MISALIGNMENT	
AXIAL DEFLECTION	± 1 mm
ANGULAR DEFLECTION	0.75°
RADIAL MISALIGNMENT	0.013mm

SR.NO.	DESCRIPTION	MATERIAL	QTY.
9	CLEVELOCK NUT	GR. 10	12
8	COUPLING BOLT	AH BOLT GR. 12.9	12
7	ATTACHMENT BOLT (III)	AH BOLT GR. 12.9	12
6	SLEEVE	ASTM A 1040	6
5	ELEMENT BLADE ASSEMBLY	SS 301	2
4	SPACER	ASTM A-106B , ASTM A-36	1
3	ADAPTER III/IV	ASTM A 1040	2
2	DRIVEN HUB (III)	ASTM A 1040	1
1	DRIVE HUB (III)	ASTM A 1040	1

REV	DMRN NO.	DESCRIPTION	REV. BY	APPD. BY	DATE

TITLE: REM-370(161) III/III /XXXX CPLG	MATERIAL: REFER TABLE	AUTHORITY	INITIALS	SIGN	DATE
CUSTOMER NAME:		DRAWN	-	-	-
		CHECKED	-	-	-
		APPROVED	-	-	-
		SCALE: 1:9	REF. NO.		
		ANG. OF PROJ.	REF. NO.		
		RATHI TRANSPOWER PVT LTD PUNE-411014			DRG.NO.: XXXX

This drawing/information/design is the property of Rathi Transpower Pvt. Ltd. It is confidential & must not be made public or copied without prior written authorization & is subjected to recall at any time. Acceptance of this drawing constitutes full arrangements with these conditions.