

ERP CODE: _____

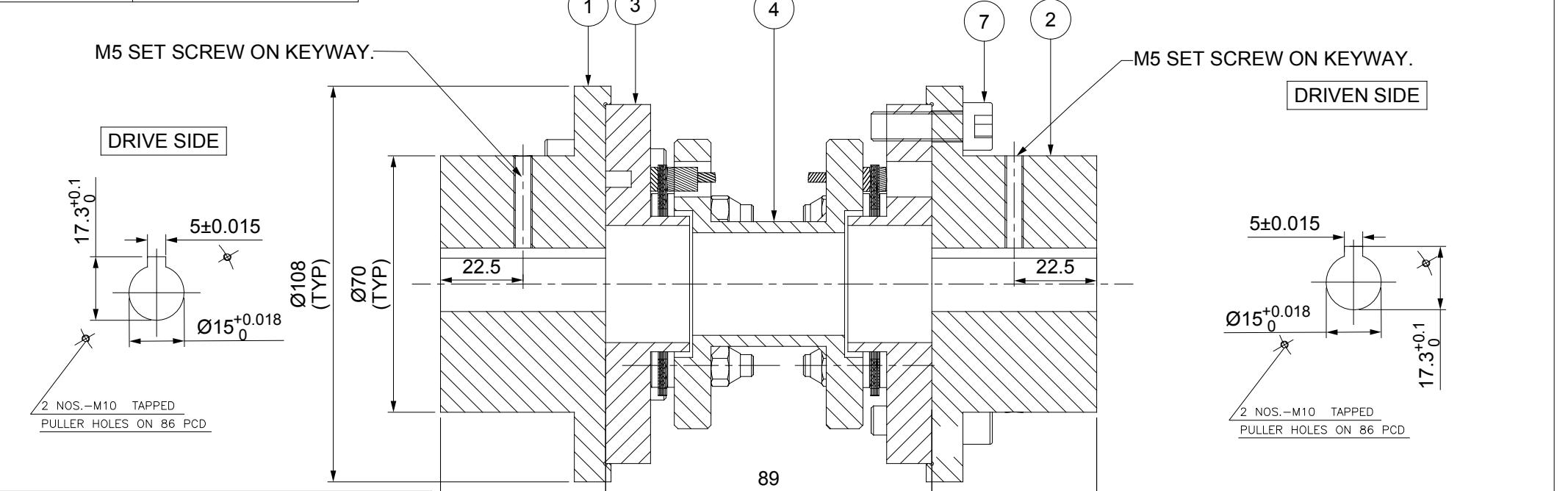

APPLICATION DETAILS	
APPLICATION	-
RATED POWER	-
RATED SPEED	-
RATED TORQUE	-
A.S.F.	-
COUPLING SPECIFICATIONS	
COUPLING RATING	2.40 KW @ 100 RPM
RATED TORQUE	232 Nm
MAX. BORE	48 mm
WEIGHT (Approx.)	5.507 kg
INERTIA (WK ²)	0.006 kg.M ²
TORSIONAL STIFFNESS	0.043 MNm/rad
CPLG DYNAMIC BALANCED TO GR 6.3 AS PER ISO 1940- 1	
MAX. MISALIGNMENT	
AXIAL DEFLECTION	± 1 mm
ANGULAR DEFLECTION	0.75°
RADIAL MISALIGNMENT	0.013mm

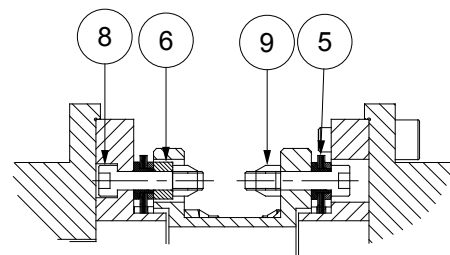

TIGHTENING TORQUE :-
 1) SR.NO.8 COUPLING BOLT = 12.1 Nm
 2) SR.NO.7 ATTACHMENT BOLT = 29 Nm

SR.NO.	DESCRIPTION	MATERIAL	QTY.
9	CLEVELOCK NUT	GR. 10	12
8	COUPLING BOLT	AH BOLT GR. 12.9	12
7	ATTACHMENT BOLT(III)	AH BOLT GR. 12.9	12
6	S SLEEVE	ASTM A 1040	6
5	ELEMENT BLADE ASSEMBLY	SS 301	2
4	SPACER	ASTM A 1040 / ASTM A 36, ASTM A106B	1
3	ADAPTER III/IV	ASTM A 1040	2
2	DRIVEN HUB (III)	ASTM A 1040	1
1	DRIVE HUB (III)	ASTM A 1040	1

REV	DMRN NO.	DESCRIPTION	REV. BY	APPD. BY	DATE

TITLE: REM-25(89) III/III /XXXX CPLG

MATERIAL: REFER TABLE

AUTHORITY INITIALS SIGN DATE

DRAWN - - -

CHECKED - - -

APPROVED - - -

CUSTOMER NAME: _____

SCALE: 1:1 REF. NO. _____

ANG. OF PROJ.

DRG.NO.: XXXX

RATHI RATHI TRANSPOWER PVT LTD PUNE-411014

This drawing/information/design is the property of Rathi Transpower Pvt. Ltd. It is confidential & must not be made public or copied without prior written authorization & is subjected to recall at any time. Acceptance of this drawing constitutes full arrangements with these conditions.