

ERP CODE: \_\_\_\_\_

M6 SET SCREW ON KEYWAY.

DRIVE SIDE

M6 SET SCREW ON KEYWAY.

DRIVEN SIDE

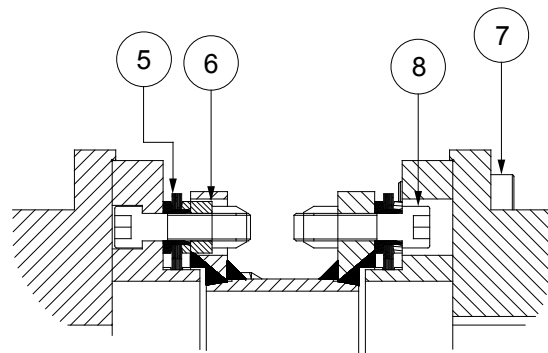
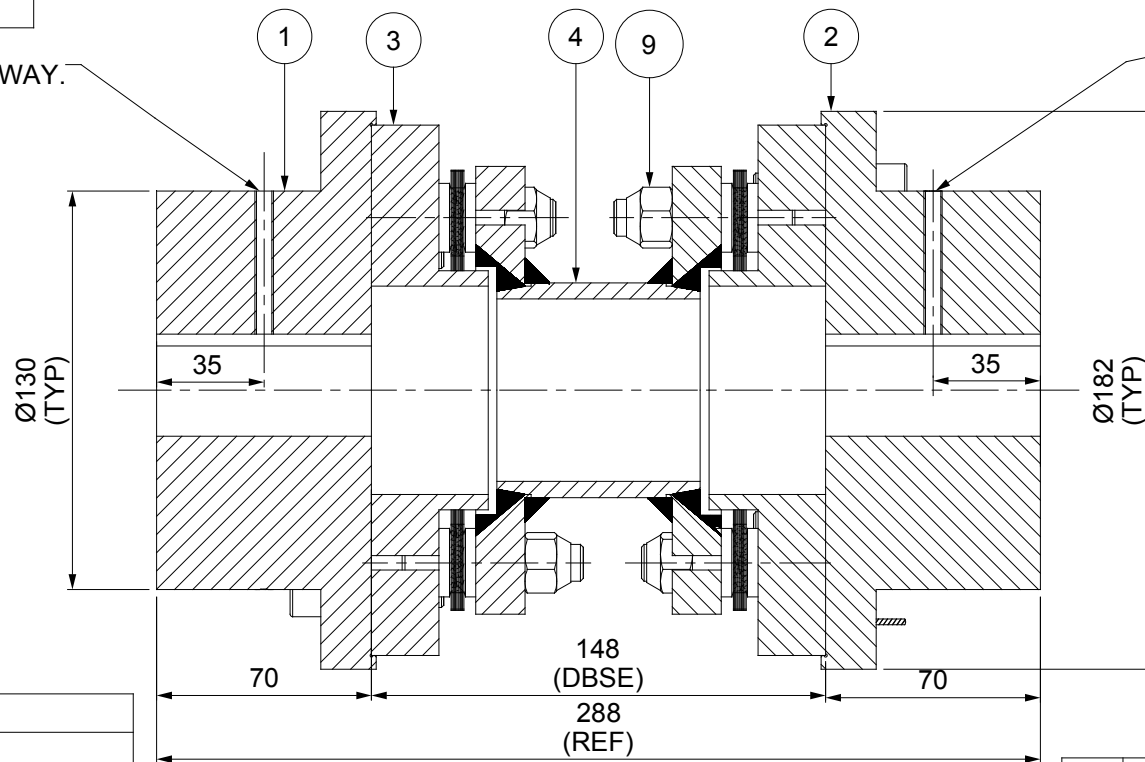
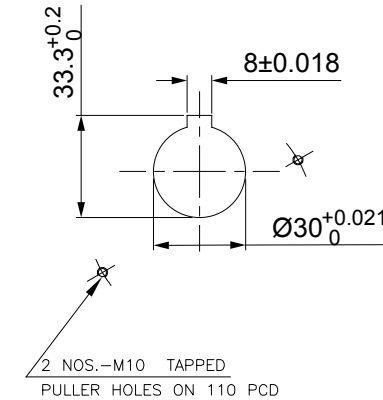
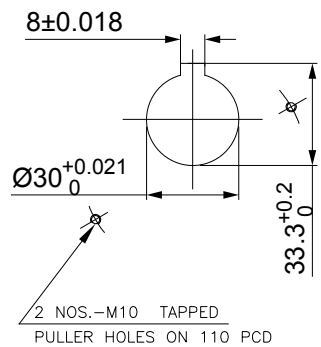

TIGHTENING TORQUE :-

- 1) SR.NO.8 COUPLING BOLT = 102 Nm
- 2) SR.NO.7 ATTACHMENT BOLT = 59 Nm

APPLICATION DETAILS

APPLICATION	-
RATED POWER	-
RATED SPEED	-
RATED TORQUE	-
A.S.F.	-

COUPLING SPECIFICATIONS

COUPLING RATING	20.0 KW @ 100 RPM
RATED TORQUE	1912 Nm
MAX. BORE	90 mm
WEIGHT (Approx.)	28.724 kg
INERTIA (WK <sup>2</sup> )	0.095 kg.M <sup>2</sup>
TORSIONAL STIFFNESS	0.395 MNm/rad

CPLG DYNAMIC BALANCED TO GR.6.3 AS PER ISO 1940- 1

MAX. MISALIGNMENT

AXIAL DEFLECTION	± 1 mm
ANGULAR DEFLECTION	0.75°
RADIAL MISALIGNMENT	0.013mm

9	CLEVELOCK NUT	GR. 10	12
8	COUPLING BOLT	AH BOLT GR. 12.9	12
7	ATTACHMENT BOLT (III)	AH BOLT GR. 12.9	12
6	S SLEEVE	ASTM A 1040	6
5	ELEMENT BLADE ASSEMBLY	SS 301	2
4	SPACER	ASTM A 1040 / ASTM A 36, ASTM A106B	1
3	ADAPTER III/IV	ASTM A 1040	2
2	DRIVEN HUB (III)	ASTM A 1040	1
1	DRIVE HUB (III)	ASTM A 1040	1
SR.NO.	DESCRIPTION	MATERIAL	QTY.

TITLE:	REM-165(140) III/III /XXXX CPLG	MATERIAL:	REFER TABLE	AUTHORITY	INITIALS	SIGN	DATE
CUSTOMER NAME:				DRAWN	-	-	-
				CHECKED	-	-	-
				APPROVED	-	-	-
				SCALE: 1:1	REF. NO.		
				ANG. OF PROJ.	REF. NO.		



RATHI TRANSPOWER PVT LTD  
PUNE-411014

DRG.NO.:  
XXXX

REV	DMRN NO.	DESCRIPTION	REV. BY	APPD. BY	DATE

This drawing/information/design is the property of Rath Transpower Pvt. Ltd. It is confidential & must not be made public or copied without prior written authorization & is subjected to recall of any time. Acceptance of this drawing constitutes full arrangements with these conditions.