

ERP CODE:

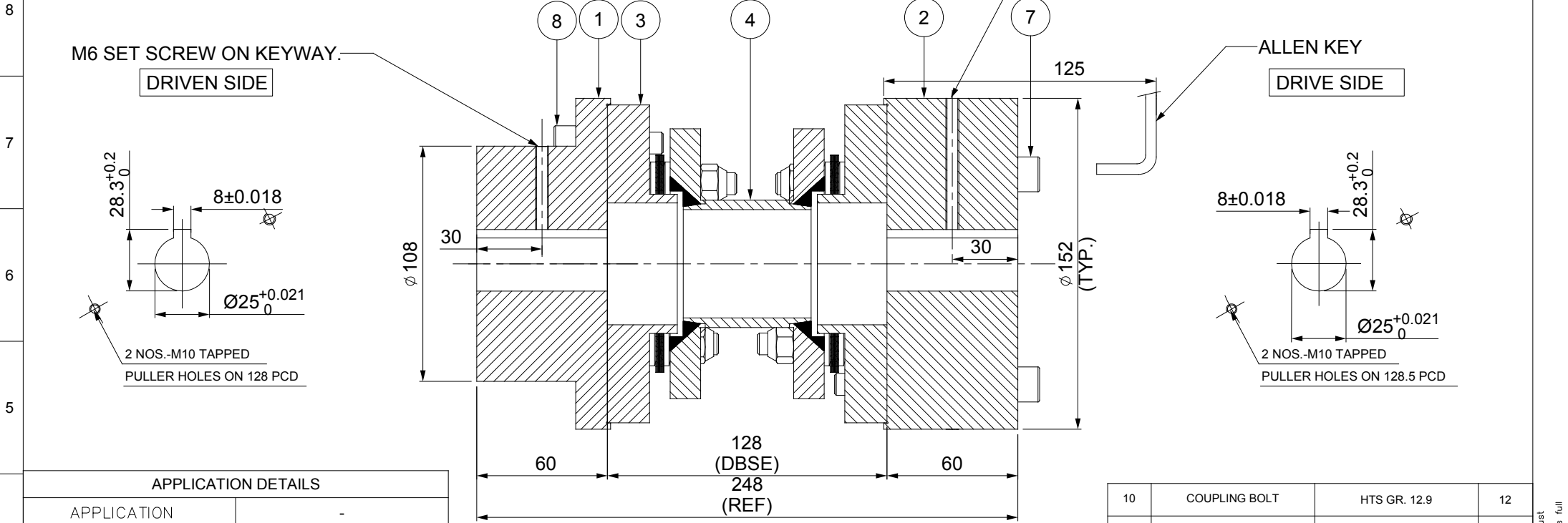

APPLICATION DETAILS	
APPLICATION	-
RATED POWER	-
RATED SPEED	-
RATED TORQUE	-
A.S.F.	-
COUPLING SPECIFICATIONS	
COUPLING RATING	12.6 KW @ 100 RPM
RATED TORQUE	1204 Nm
MAX. BORE	HUB (III)-80 mm HUB (IV)-102 mm
WEIGHT (Approx.)	20.560 kg
INERTIA (WK^2)	0.055 kg.M ²
TORSIONAL STIFFNESS	0.232 MNm/rad
CPLG DYNAMIC BALANCING TO GR 6.3 AS PER ISO 1940- 1	
MAX. MISALIGNMENT	
AXIAL DEFLECTION	± 1 mm
ANGULAR DEFLECTION	0.75°
RADIAL MISALIGNMENT	0.013mm

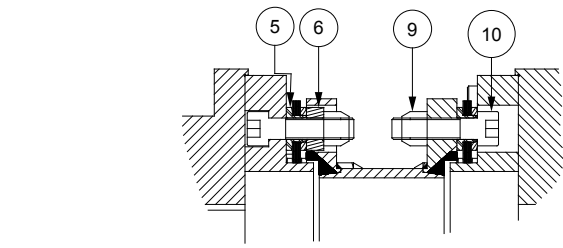

NOTE:-
TIGHTENING TORQUE :-
 1) SR.NO.10 COUPLING BOLT = 59Nm
 2) SR.NO.7 & 8 ATTACHMENT BOLT = 59Nm

REV	DMRN NO.	DESCRIPTION	REV. BY	APPD. BY	DATE

SR.NO.	DESCRIPTION	MATERIAL	QTY.
10	COUPLING BOLT	HTS GR. 12.9	12
9	CLEVELOCK NUT	HTS GR. 10	12
8	ATTACHMENT BOLT(III)	HTS GR. 12.9	6
7	ATTACHMENT BOLT (IV)	HTS GR. 12.9	6
6	SLEEVE	ASTM A 1040	6
5	ELEMENT BLADE ASSEMBLY	SS 301	2
4	SPACER	ASTM A 1040/ASTM A106B, ASTM A36	1
3	ADAPTER III/IV	ASTM A 1040	2
2	DRIVE HUB (IV)	ASTM A 1040	1
1	DRIVEN HUB (III)	ASTM A 1040	1

TITLE: REM-125(128) III/IV/ XXXX CPLG	MATERIAL: REFER TABLE	AUTHORITY	INITIALS	SIGN	DATE
CUSTOMER NAME:		DRAWN	-	-	-
		CHECKED	-	-	-
		APPROVED	-	-	-
		SCALE: NTS	REF. NO.		
		ANG. OF PROJ.			
		RATHI TRANSPOWER PVT LTD PUNE-411014			DRG.NO.: L/REM-XXXX/0

This drawing/ information/ design is the property of Rathi Transpower Pvt. Ltd. It is confidential & must not be made public or copied without prior written authorization & is subjected to recall at any time. Acceptance of this drawing constitutes full arrangements with these conditions.